

ENGINEERED TO LAST.
DESIGNED TO PERFORM.

280X

AVAILABLE IN : 280X 1-DOG UNIT, 280X 2-DOG UNIT

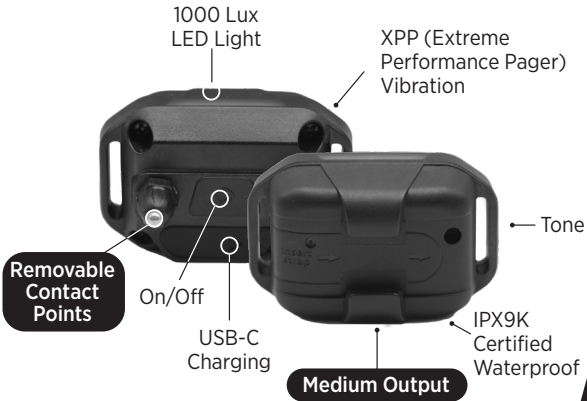

HERE IS OUR CHECKLIST FOR YOU TO START

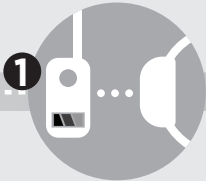

1 Always double check your battery life and connection of the unit

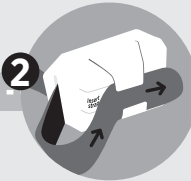

2 Pass the strap through the left, center, and right loops according to the direction of the arrow and fasten it



3 The best position is on either side of the dog's neck. Ensure a snug fit making skin contact*

⏪ TAKE YOUR TIME THIS IS NOT A RACE



5 Make sure your dog understands commands before layering the e-collar over



4 Know your dog's conditioning level**

ⓘ Please reference following chapters in the online manual for more details:
* <How to use the receiver>
** <Get Maximum Distance>



6 Use positive reinforcement as needed when training with the e-collar



7 Do not attach leash to E-Collar Strap



For more details & troubleshooting, check out the full online manual here!



TURNING THE UNIT ON/OFF



- Green = Full charge**
- Amber = Medium charge**
- Red = Needs charge**

The remote transmitter's power button is located on the bottom right. The receiver's collar power button is located between the contacts. Press and hold the power button for 2 seconds to turn it on or off. The LED indicator will turn solid green with a tone when the unit powers on and a red light with a tone when it powers off. (Press the power button briefly to turn on the backlight.)

PROGRAMMING BETWEEN NICK AND CONSTANT

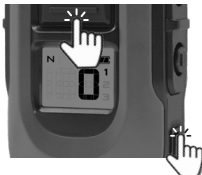

N NICK or **C** CONSTANT

- 1) Set the stimulation level to "0".
- 2) Hold both the main front button and side power button together for 5 seconds to program Nick or Constant mode. The selected mode will be displayed on the top of the LCD screen.

SIDE BUTTONS

1) Boosted Constant



2) Tone

3) XPP Vibration

4) Locate Light

① LCD Display

TO NE	PAGER	LIGHT

1) Boosted Constant

Boosted Constant button customizes your desired immediate level jump without having to manually increase the level, which can be applied up to 12 seconds. To set up, please follow the below steps:

- 1) Set the level at "0".
- 2) Hold the Boosted Constant button until LED light on the transmitter is blinking.
- 3) Use the rheostat dial to select the Incremental Amount to jump.
- 4) Press the Boosted Constant button again to complete the set up.

① Example

Selecting "5" as the Incremental Amount for the Boosted Constant button will apply the output level of displayed level + 5, as shown below.

Base Displayed Level	Incremental Amount	Boosted Constant Output
1	+5	6
5	+5	10

Applies Displayed Base Level. In this case, level 5 'Nick' will apply.



Applies 'Boosted Constant' for up to 12 seconds. In this case, level 10 'Constant' will apply.



2) Tone

Emits a beeper tone without applying stimulation for up to 12 seconds.

3) XPP (Extreme Performance Pager) Vibration

Provides a non stimulating vibration for up to 12 seconds.

4) LED Locate Light

Uses a 1000 lux LED Light on the receiver to locate your dog in the dark.

- For continuous blinking, every 4 seconds, tap the Locate Light button once. To disable the continuous blinking, tap Locate button again.

- To manually enable the continuous blinking, press and hold the Locate Light button which can stay blinking for up to 12 seconds.

CHARGING THE BATTERY

Use the 2-port USB-C battery charger to charge the receiver and transmitter concurrently. You can use other USB-C cable to charge individually. For optimal performance, only use Dogtra-approved batteries and accessories for your Dogtra e-collars.

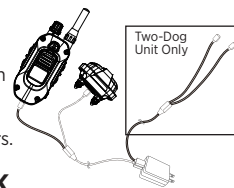

SAFETY STIMULATION LEVEL LOCK

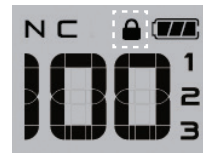

Stimulation level lock indicator

To prevent the stimulation level from changing unintentionally, press down the top of the Rheostat dial for more than 2 seconds to lock it. When locked, a lock icon will appear on the LCD screen. To unlock, press down the top of the Rheostat dial for more than 2 seconds.

HOW TO ADD ADDITIONAL RECEIVER DEVICES



1. Turn on the transmitter and set the stimulation level to "0". Use the toggle to select the desired dog (1,2 or 3).



2. To begin pairing receiver must be off. Initiate pairing mode by pressing and holding the power button for 5 seconds until the LED starts blinking and then release.



3. Simultaneously press the front transmitter button and side Boost button until the screen reads "CD****" then release. Confirm successful pairing by pressing Pager vibration.

Repeat the pairing process if the pager vibration test is unsuccessful. The pairing between the devices has timed out or failed.

CD**** : Product ID CODE

IMPORTANT SAFETY AND PRODUCT INFORMATION

WARNING

Please read all safety and product information below before using your Dogtra product. Failure to follow these safety instructions could result in injury to you, your dog and others, or it could result in damage to your Dogtra product or other property.

PRODUCT SAFETY

Training Methods

Dogtra products may be used with a variety of training methods. However, each dog may have a different reaction to training methods and to Dogtra products. Closely observe your dog when determining the right training method to use with your Dogtra product.

Aggressive Dogs

Do not use Dogtra products with aggressive dogs as such dogs may react adversely and cause injury to people or other dogs. Seek the assistance of a dog-training specialist or veterinarian when dealing with aggressive dogs.

Children

Dogtra products are not toys. Adult supervision and close attention are necessary when Dogtra products are used by or near children.

PRODUCT DAMAGE

Electrical Product

Your Dogtra product contains electrical components and batteries. Do not use or keep your product near heat or flammable sources. Such use or storage may damage your product and/or cause fire, explosion, injury, or property damage.

Medical Device Interference

Dogtra products contain electrical and magnetic components that emit low level electromagnetic waves and radio frequencies. These electromagnetic

waves or radio frequencies may interfere with pacemakers, defibrillators, or other medical devices. Consult your physician or medical device maker before using your medical device around a Dogtra product. If you think that your Dogtra product is interfering with your pacemaker, defibrillator, or other medical device, stop using the Dogtra product.

Inadvertent Activation

The digital microprocessor offers thousands of unique codes to eliminate frequency match-up with other Dogtra e-collars. The Constant button will automatically shut down after being held down for 12 seconds or more as a safety feature.

UNAUTHORIZED USE

Your Dogtra product should be used only in a humane manner to train and educate your dog. Dogtra products are not intended for use in any other manner nor are they intended for use with other animals or with humans.

BATTERY

Your Dogtra product contains batteries. Take care when removing and installing batteries as your fingers may get caught. Dispose of batteries as provided by your local regulations. Do not disassemble, crush, heat, or otherwise alter the battery as it may cause fire, injury or property damage.

FCC WARNING STATEMENT

This device complies with part 15 of the FCC Rules. Operation is subject to the following two conditions: (1) This device may not cause harmful interference, and (2) this device must accept any interference received, including interference that may cause undesired operation.

Happy Training! Share your remote training experience by leaving us a review!

